

Female Female Rubber Vibration Mounts

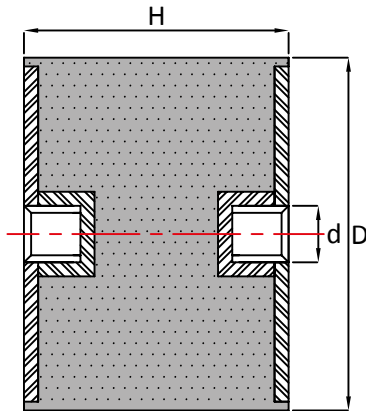

D x H	d	45° Shore A	60° Shore A	70° Shore A	mm
15 x 15	M4	6.1	11.2	15.8	1.3
20 x 15	M6	7.9	14.8	20.5	1.0
20 x 20	M6	7.4	13.7	18.9	1.6
20 x 25	M6	7.0	12.6	17.8	2.2
20 x 30	M6	5.6	10.0	14.1	2.6
25 x 15	M6	15.7	30.0	42.0	1.0
25 x 20	M6	16.8	31.0	41.0	1.6
25 x 25	M6	13.0	25.0	34.0	2.1
25 x 25	M8	13.0	25.0	34.0	2.1
25 x 30	M8	10.4	20.7	30.4	2.6
30 x 20	M8	15.7	30.0	40.0	1.2
30 x 25	M8	18.0	31.0	42.0	2.1
30 x 30	M8	15.8	30.0	40.0	2.6
30 x 35	M8	15.0	29.0	39.0	3.1
30 x 40	M8	14.7	29.0	38.0	3.6
40 x 20	M8	32.0	61.0	88.0	1.2
40 x 30	M8	35.0	65.0	91.0	2.6
40 x 30	M10	35.0	65.0	91.0	2.6
40 x 35	M8	27.0	54.0	79.0	2.5
40 x 35	M10	27.0	54.0	79.0	2.5
40 x 40	M8	31.0	57.0	78.0	3.6
40 x 40	M10	31.0	57.0	78.0	3.6
40 x 45	M10	30.0	56.0	77.0	4.1
50 x 25	M10	76.0	140.0	193.0	2.1
50 x 30	M10	71.0	131.0	180.0	2.5
50 x 35	M10	62.0	115.0	158.0	3.0
50 x 40	M10	51.0	95.0	132.0	3.5
50 x 45	M8	46.0	86.0	120.0	4.0
50 x 45	M10	46.0	86.0	120.0	4.0
50 x 50	M10	42.0	86.0	109.0	4.5
50 x 60	M10	38.0	80.0	105.0	5.4
60 x 35	M12	111.0	260.0	285.0	3.1

D x H	d	45° Shore A	60° Shore A	70° Shore A	mm
60 x 40	M10	103.0	192.0	261.0	3.5
60 x 40	M12	103.0	192.0	261.0	3.5
60 x 45	M10	93.0	174.0	241.0	4.0
60 x 45	M12	93.0	174.0	241.0	4.0
60 x 50	M12	84.0	156.0	215.0	4.5
65 x 35	M12	135.0	252.0	348.0	3.0
70 x 30	M10	178.0	330.0	450.0	2.4
70 x 35	M10	157.0	312.0	430.0	2.9
70 x 35	M12	157.0	312.0	430.0	2.9
70 x 40	M10	145.0	270.0	375.0	3.4
70 x 45	M10	130.0	240.0	327.0	3.9
70 x 45	M12	130.0	240.0	327.0	3.9
70 x 50	M10	120.0	220.0	305.0	4.4
70 x 50	M12	120.0	220.0	305.0	4.4
70 x 60	M12	118.0	218.0	300.0	5.4
70 x 70	M10	113.0	210.0	290.0	6.4
75 x 40	M12	157.0	290.0	400.0	3.4
75 x 45	M12	155.0	285.0	392.0	3.9
75 x 50	M12	150.0	280.0	390.0	4.4
75 x 55	M12	130.0	245.0	340.0	4.9
75 x 60	M12	115.0	190.0	300.0	5.2
95 x 75	M12	225.0	450.0	661.5	6.7
95 x 75	M16	225.0	450.0	661.5	6.7
100 x 40	M16	390.0	700.0	970.0	3.2
100 x 45	M16	345.0	625.0	865.0	3.7
100 x 50	M16	305.0	550.0	760.0	4.2
100 x 55	M16	280.0	520.0	720.0	4.7
100 x 60	M16	270.0	490.0	680.0	5.2
100 x 100	M16	175.0	305.0	430.0	9.2
105 x 75	M16	325	650	955.5	6.7
120 x 75	M16	390	780	1146.6	6.7
150 x 75	M20	405.0	725.0	1010.0	6.7

Max compression load in Kg deflection in mm.

This information is for guidance only. Customers are recommended to contact us for further technical information on products and applications. We reserve the right to alter specifications or withdraw products without notice.